

Deleting an Item

- 23. Turn both of the Adder module's **Gain** controls fully clockwise.
- 24. Connect the Master Signals module's **2.08kHz SINE** output to both of the Adder module's inputs.
- 25. Resize the Adder module's output signal on the scope's display by adjusting Channel 2's **Scale** control to an appropriate setting.
- 26. Measure the Adder module's new output voltage. Record your measurement as part of the following question.



Deleted Items **cannot**
be undone

Navigate to item you want to delete and **click to open**

1

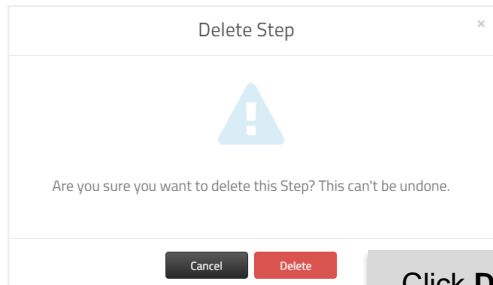

Click **Delete** or
Cancel

3

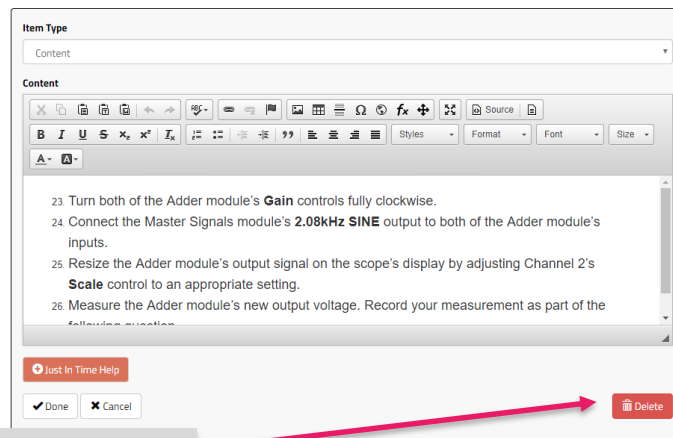

Click **Delete**

2